



THE TESTS OF SHIPPING,
ROUGH JOB SITE HANDLING
AND SEVERE WEATHER CONDITIONS
SEPARATE THE STRONG INSULATIONS
FROM THE REST

STURDY-R™ has the muscle to withstand adverse conditions.

An insulation product's strength is often associated with its ability to keep a house comfortable and energy efficient. There are times, however, when your insulation needs extra resilience to stand up to excessive job site abuse, so you can avoid costly repairs or product replacement. STURDY-R™ polyisocyanurate insulation helps builders face such rough conditions without enduring extra costs for damaged insulation boards.

STURDY-R insulation is the solution for challenging installation environments for builders. It is one of the strongest, most damage-resistant foam sheathings available. STURDY-R insulation is versatile and can be used in numerous residential applications. It is designed to withstand the less-than-ideal situations sometimes present during shipping and on the job site.

Benefits

What gives STURDY-R insulation its exceptional strength are two highly durable exterior facers that sandwich a closed-cell polyisocyanurate foam core. These proprietary fiberglass facers are bonded to the foam core with a superior resin, making STURDY-R insulation the best choice when durability is the primary consideration. Recommended for wall sheathing in residential applications,

its durability means you can focus on the job at hand rather than spending time and money replacing broken boards.



MEETS R-VALUE NEEDS

STURDY-R insulation is produced in a range of R-values¹ to fit your specific needs. Compliance with energy code requirements is simplified for conventional 2" x 4" frame construction and supplemental fiberglass insulation.

STURDY-R insulation covers the entire wall surface as well – not just the area between the studs. Wood framing (studs) can account for up to 25 percent of the wall area, which means one quarter of a typical home's surface is uninsulated. This creates a thermal short circuit and lets energy escape from your home. Providing an envelope of STURDY-R insulation to a home can help you reduce this energy loss.

HIGHLY VERSATILE APPLICATIONS – INCLUDING RESIDING

Install STURDY-R insulation as exterior sheathing in residential applications wherever you would use more traditional sheathings.² As a rigid substrate, STURDY-R insulation can be used for nearly any type of siding. It is easy and cost-efficient to install under most exterior claddings and provides a smooth, strong base for residing. With a perm rating of about 3, STURDY-R is one of the higher perm insulating sheathings on the market.

When you need an insulation sheathing to deliver tough, durable performance to reduce damage – and costs – on the job site, STURDY-R insulation is your solution.

¹R-value means resistance to heat flow. The higher the R-value, the greater the insulating power.

²Consult with your local building code department for sheathing requirements.

DURABLE, YET EASY TO HANDLE AND INSTALL

Just because STURDY-R™ insulation can stand up to harsh job site conditions doesn't mean it's hard to handle. Remarkably durable STURDY-R insulation is lightweight and easy to cut to specific shapes and sizes. A range of available thicknesses and board sizes enable energy-efficient designs at the lowest material cost (Table 1).

Simply fastened with nails or staples, STURDY-R insulation installs quickly and easily to wood or metal studs and masonry substrates. And the fibrous composition of STURDY-R allows it to accept a staple from a high-pressure staple gun better than most other insulations.

TABLE 1

Available Sizes of STURDY-R Polyisocyanurate Insulation ¹		
Thickness	Board Size	R-Value ²
1/2"	4' x 8'; 4' x 9'	2.5
.59"	4' x 8'; 4' x 9'	3.0
3/4"	4' x 8'; 4' x 9'	4.0
1"	4' x 8'; 4' x 9'	5.0

¹Not all product sizes are available in all regions. Please contact your local Dow sales representative for specific product availability in your area.

²R means resistance to heat flow. The higher the R-value, the greater the insulating power. R-value determined by ASTM C518.

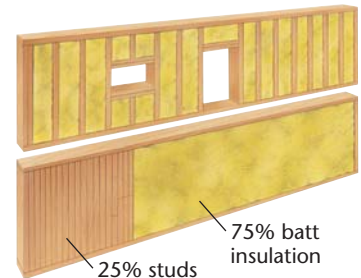

Leaving studs uninsulated is like leaving an entire wall exposed. STURDY-R insulation reduces energy costs because it insulates studs and cavities.

To learn how STURDY-R insulation can help you get a tough job done, call your Dow representative.

NOTICE: Changes to the International Residential Code (IRC) require the installation of a weather-resistive barrier within most exterior wall assemblies in residential construction. The following Dow insulated sheathing products qualify as a weather-resistive barrier (WRB) when installed according to the installation instructions developed for "installation of foam sheathing as a weather-resistive barrier": STYROFOAM® DURAMATE® Plus, STYROFOAM Residential Sheathing, STYROFOAM Tongue & Groove, STYROFOAM Square Edge, STYROFOAM Residing Board, THERMAX®, TUFF-R®, and Super TUFF-R and therefore do not require the use of a building paper or a housewrap as a WRB. When a WRB is not needed, these Dow foam sheathings may be installed according to standard installation instructions for foam sheathing from Dow. Be sure products and installation procedures meet code requirements for your particular location.

NOTE: STYROFOAM WEATHERMATE® and STYROFOAM WEATHERMATE Plus housewraps have already qualified as weather resistive alternatives to the prescribed felt (see Evaluation Reports NER 593 and NER 640 for approved alternate).

NOTICE: No freedom from any patent owned by Dow or others is to be inferred. Because use conditions and applicable laws may differ from one location to another and may change with time, Customer is responsible for determining whether products and the information in this document are appropriate for Customer's use and for ensuring that Customer's workplace and disposal practices are in compliance with applicable laws and other government enactments. Dow assumes no obligation or liability for the information in this document. NO WARRANTIES ARE GIVEN; ALL IMPLIED WARRANTIES OF MERCHANTABILITY OR FITNESS FOR A PARTICULAR PURPOSE ARE EXPRESSLY EXCLUDED.

COMBUSTIBLE: Protect from high heat sources. Local building codes may require a protective or thermal barrier. For more information, consult MSDS, call Dow at 1-866-583-BLUE (2583) or contact your local building inspector. In an emergency, call 1-989-636-4400.

NOTE: Building and/or construction practices unrelated to insulation or housewrap could greatly affect moisture and the potential for mold formation. No material supplier, including Dow, can give assurance that mold will not develop in any specific system.

THE DOW CHEMICAL COMPANY • Building & Construction • 200 Larkin • Midland, MI 48674
 FOR TECHNICAL INFORMATION: 1-866-583-BLUE (2583) • FOR SALES INFORMATION: 1-800-232-2436
www.insulateyourhome.com



roofs
 ceilings
 attics
 walls
 sills
 slabs
 foundations